

Load type	Shear	Tension	Compression
Breaking load (BL)	420 kN	500 kN	2000kN
Safe Working Load (SWL)	210 kN	250 kN	1000kN

Date: 29-07-2021

Revision no.: 001

Color/finish: Hot Dip Galvanised

Weight: 6.4kg

Material: Blank Steel

Comment: units in mm

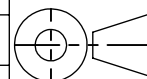

Scale: 1:2.5

Drawn: K. van Puffelen

Checked: S. Saeys

## Dovetail Twistlock 55° - Left Locking



A4

Drawingno.:

**BD-E1-L**

© Van Doorn Container Parts BV. All parts contained in this document is protected by the intellectual works of van Doorn container parts BV. Any form of copying, manufacturing or distribution towards third parties is strictly forbidden without the written permission of Van Doorn Container Parts BV. All care has been taken to prevent incorrectness, however Van Doorn Container Parts BV cannot be held responsible for incompleteness resulting from information contained by this document. All rights are reserved by Van Doorn Container Parts BV.

[www.containerparts.nl](http://www.containerparts.nl) / [vandoorn@containerparts.nl](mailto:vandoorn@containerparts.nl) / +31 (0)10-4296030